

Xantrex™ Communications Gateway



xanbus.
ENABLED

Xantrex™ Communications Gateway helps the user stay informed with computer access or a simple report

The Xantrex™ Communication Gateway bridges the gap between a Xantrex GT or XW System and the system owner's computer, making it the central component for a residential or small commercial remote monitoring system.

The Gateway logs performance data directly from the Xantrex GT or XW System, and transmits it to the included Yahoo™ Widget based monitoring software for a simple and graphically rich view of system performance. More than a data logger, the Gateway offers a web page with the ability to configure automated email reports and fault status to the user or installer.

The Gateway includes both built-in Wi-Fi and Ethernet connectivity allowing for flexible and simple set up for wireless or wired connection to a router or direct to a PC.

The Gateway logs and transmits performance data such as:

- ▶ System power production
- ▶ Inverter specific power production
- ▶ Lifetime energy production; daily, weekly, monthly energy production graphs
- ▶ Inverter faults with date and time stamp

Product Features

- ▶ Can monitor a network consisting of up to 20 single phase GT inverters and up to 8 XW devices (XW inverter(s), XW Charge Controller(s), XW SCP, and XW AGS)
- ▶ Wi-Fi/Ethernet module with 10/100 Base-T or 802.11 b/g
- ▶ Can be configured to send energy and alarm reports via email
- ▶ Graphical interactive solar monitoring software
- ▶ Embedded web page for configuring the Gateway and upgrading inverter firmware
- ▶ 16 megabytes of storage

Xantrex Technology Inc.

Headquarters

8999 Nelson Way
Burnaby, British Columbia
Canada V5A 4B5
+1 800 670 0707 Toll Free
+1 604 420 1591 Fax

Europe

Xantrex Technology GmbH
Steinheimer Str. 117
63500 Seligenstadt, Germany
+49 (0) 6182 81 6000 Tel
+49 (0) 6182 81 6001 Fax

Xantrex Technology S.L.
Bac de Roda, 52 edificio A
08019 Barcelona, Spain
+34 93 433 8350 Tel
+34 93 433 8351 Fax

europesales@xantrex.com



Our evolution to Schneider Electric, the global specialist in energy management, re-affirms our commitment to provide you with innovative solutions, best-in-class customer service, and exceptional quality in everything we do. We are proud to be your partner, and we are dedicated to helping you make the most of your energy.

www.xantrex.com

Xantrex™ Communications Gateway

Electrical Specifications	
Communication	Physical layer 2, CAN
Communication protocol	Xanbus™
Maximum Xanbus cable length	130 ft (40 m)
Maximum Ethernet cable length	195 ft (60 m)
Connectors	3 RJ-45 – 8 pins (2 Xanbus, 1 Ethernet)

Communication Specifications	
Ethernet	IEEE Std 802.3™-2005
Wireless	802.11.4b and 802.11.4g; WEP and WPA security Channels 1-11 (US/Canada), 1-9 (Europe)
Part number	865-1055 (US/Canada), 865-1056 (Europe)

Mechanical Specifications	
Dimensions (H x W x D)	4 x 6 x 1" (112 x 190 x 45 mm)
Height including antenna	9" (249 mm)
Weight	0.46 lb (207 g)

Regulatory Compliance	
North America	EMC FCC part 15B class B
Industry Canada	ICES-003 class B
Europe	
Safety	Low Voltage Directive 2006/95/EC EN60950-1:2001
EMC	EMC Directive 2004/108/EC EN55022 A2: 2003 EN55024 A2: 2003
Telecom	R&TTE Directive 1999/5/EC ETSI EN 301 489-1 ver. 1.6.1 ETSI EN 301 489-17 ver. 1.2.1

Specifications subject to change without notice.

Sample Configuration

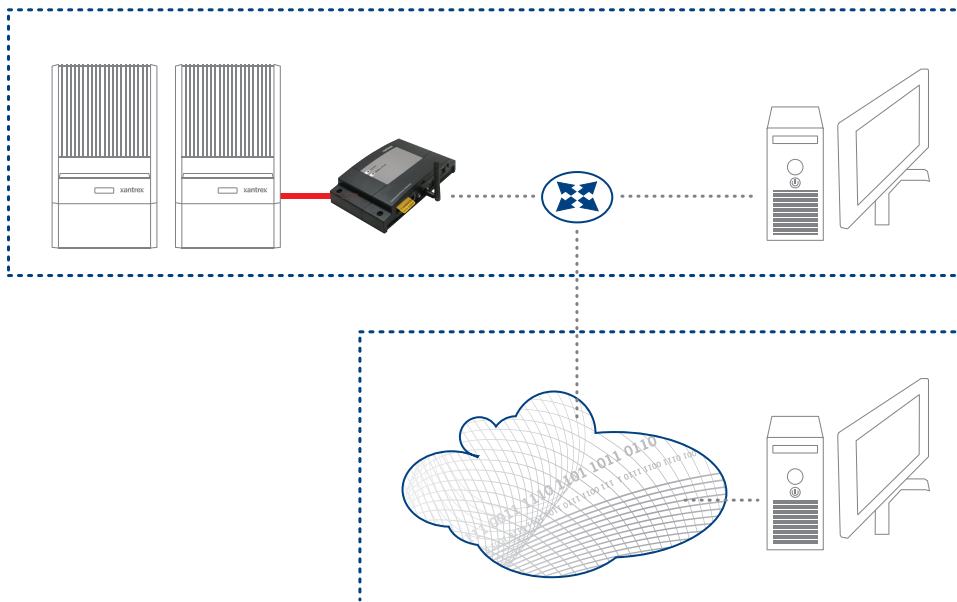

Yahoo™ Widget-based Monitoring Software

(Sample screen shots)

