

FULL BLACK LINE

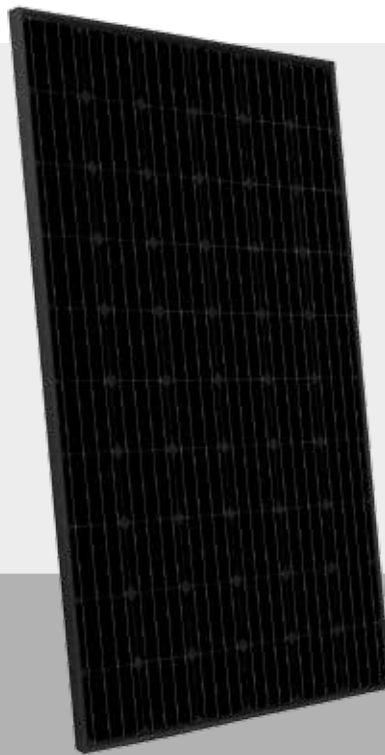

PERC TECHNOLOGY*
Passivated Emitter and Rear Cell



30 YEAR LINEAR POWER WARRANTY
ANNI GARANZIA LINEARE PRODUZIONE

20 YEAR PRODUCT WARRANTY
ANNI GARANZIA PRODOTTO

PV Module MONOCRYSTALLINE SG290M(FB)

EUROPEAN MODULE | SG 
MADE IN ITALY

PEIMAR monocrystalline solar panels, produced using a combination of innovative production processes and advanced engineering techniques, provide customers with maximum output and super high performance (over 20% efficiency). This allows fewer panels to be used to generate more energy, ideal if space is restricted or environmental conditions are challenging. Modern design, using matching black cells and frames and a very long lifespan ensure this monocrystalline are a great option.

*Thanks to the use of **PERC** cells, PEIMAR modules are able to reach even higher efficiencies, as they facilitate the light imprisonment in close proximity to the rear surface and optimise the electron capture.



POSITIVE POWER OUTPUT TOLERANCE



MODULE FIRE PERFORMANCE: CLASS I



ANTI-REFLECTIVE GLASS



HAILSTORM RESISTANCE

CELLS

60
MONO



QTY:
60 CELLS
TYPE:
MONO 4BB-5BB
PERC TECHNOLOGY 
DIMENSION:
156x156 mm / 6x6"

FRAME



BACKSHEET



JUNCTION BOX



ELECTRICAL CHARACTERISTICS (STC)*

	SG290M
Nominal Output (Pmax)	290 W
Flash Test Power Tolerance	0/+5 W
Voltage at Pmax (Vmp)	31.6 V
Current at Pmax (Imp)	9.18 A
Open Circuit Voltage (Voc)	39.6 V
Short Circuit Current (Isc)	9.55 A
Maximum System Voltage	1000 V
Maximum Series Fuse Rating	15 A
Cell Efficiency	20.93 %
Module Efficiency	17.83 %

MECHANICAL CHARACTERISTICS

Solar Cells	60 (6x10) monocrystalline PERC
Solar Cells Size	156x156 mm / 6x6"
Front Cover	3.2 mm / 0.12" thick, low iron tempered glass
Back Cover	TPT (Tedlar-PET-Tedlar)
Encapsulant	EVA (Ethylene vinyl acetate)
Frame	Anodized aluminium alloy, double wall
Frame finishing	Black
Backsheet finishing	Black
Diodes	3 Bypass diodes serviceable
Junction Box	IP65 rated
Connector	MC4 or compatible connector
Cables Length	900 mm / 35.4"
Cables Section	4.0 mm ² / 0.006 in ²
Dimensions	1640x992x40 mm / 64,5x39x1,57"
Weight	18 Kg / 39.7 lb
Max. Load	Certified to 5400 Pa

TEMPERATURE CHARACTERISTICS

NOCT**	45±2 °C
Temperature Coefficient of Pmax	-0.40 %/°C
Temperature Coefficient of Voc	-0.32 %/°C
Temperature Coefficient of Isc	0.047 %/°C
Operating Temperature	-40 °C ~ +85°C

PACKAGING***

Pallet dimensions	1700x1100x1200 mm / 67x43x47"
Pieces per pallet	27
Weight	516 Kg / 1138 lb

CERTIFICATIONS

Fire Resistance Rating	Class 1 (UNI 9177)
------------------------	--------------------

DIMENSIONS

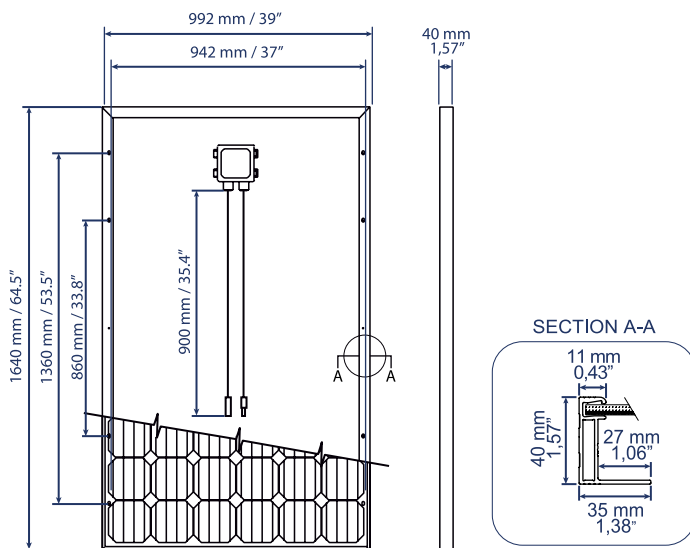

CURRENT/VOLTAGE CHARACTERISTICS

Values apply to modules: SG290M(FB)

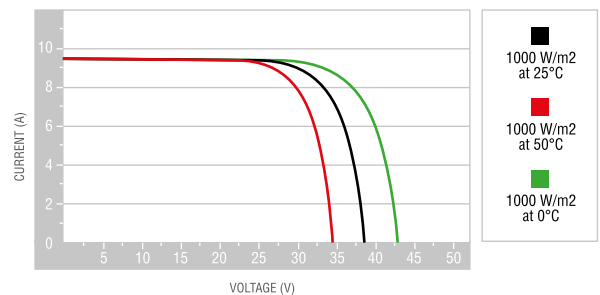
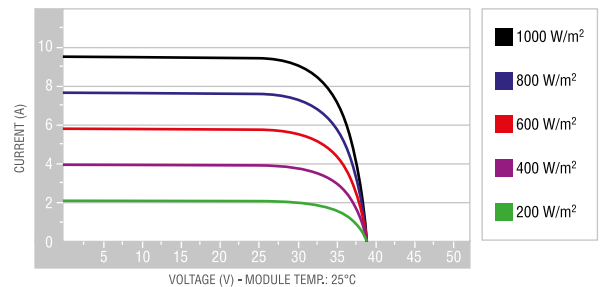

*STC (Standard Test Condition): Irradiance 1000W/m², Module Temperature 25°C, Air Mass 1.5

**NOCT: Nominal Operation Cell Temperature Sun 800W/m²; Air 20°C; Wind speed 1m/s

*** Pallets can be stacked up to two